

Wall mounting socket outlet - straight, housing dimensions 102x102 mm



Product description	
BALS-Prd.-Nr	110573
EAN	4024941938709
product category (PG)	TE wall mounting socket outlet Quick-Connect
current (A)	32A
number of poles (P99)	4p
number of poles (P)	3P+PE
position of earth contact (H)	6 h
voltage (V)	380 up to 415V

Product description	
frequency (HZ)	50 and 60Hz
protection degree (SA)	IP67
colour code 1 (KF1)	red RAL 3000
Colour of appliance	Hinged lid red RAL 3000, Enclosure grey RAL 7035
connection design (AT)	screwless spring terminals as cage clamp with Kontex-contact
maximum conductor size (LQ)	10,0 qmm
cable entry (KE)	3 sides 2x M20/25, 1 side 1x M20/25, to break out
Height	102mm
Width	102mm
Depth	134mm
dimension of enclosure (GG)	102x102 mm (HxW)
material of enclosure (GM)	Polyamide
contact	The contact carrier is made of high temperature resistant material, the contacts are brass nickel plated

Additional technical properties	
	All cable entries are to break out

Logistics data	
Weight/pcs	0.435 kg / Piece
Packaging	Bag
Content amount	1 ST

Logistics data	
EAN	4024941938709
Length	134 mm
Width	102 mm
Height	102 mm
Weight	0.436 kg
Volume	1,394.136 ccm
Packaging	Carton
Content amount	10 ST
EAN	4024941828505
Length	330 mm
Width	216 mm
Height	260 mm
Weight	4.576 kg
Volume	17,062.5 ccm

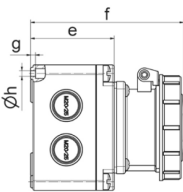
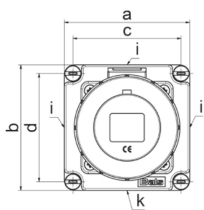

Ampere Polzahl	16 3	16 4	16 5	32 3	32 4	32 5
a	102,0	102,0	102,0	102,0	102,0	102,0
b	102,0	102,0	102,0	102,0	102,0	102,0
c	88,0	88,0	88,0	88,0	88,0	88,0
d	88,0	88,0	88,0	88,0	88,0	88,0
e	68,0	68,0	68,0	68,0	68,0	68,0
f	124,0	125,0	124,0	134,0	134,0	134,0
g	4,0	4,0	4,0	4,0	4,0	4,0
h ø	4,5	4,5	4,5	4,5	4,5	4,5
i	2xM20/25	2xM20/25	2xM20/25	2xM20/25	2xM20/25	2xM20/25
k	M20/25	M20/25	M20/25	M20/25	M20/25	M20/25
Leiter mm ² min	1,5	1,5	1,5	2,5	2,5	2,5
Leiter mm ² max	4	4	4	10	10	10

1 MB 121