

Printed board layout (1,6±0,2 thick)
view component side
(PCB plating = Tin)

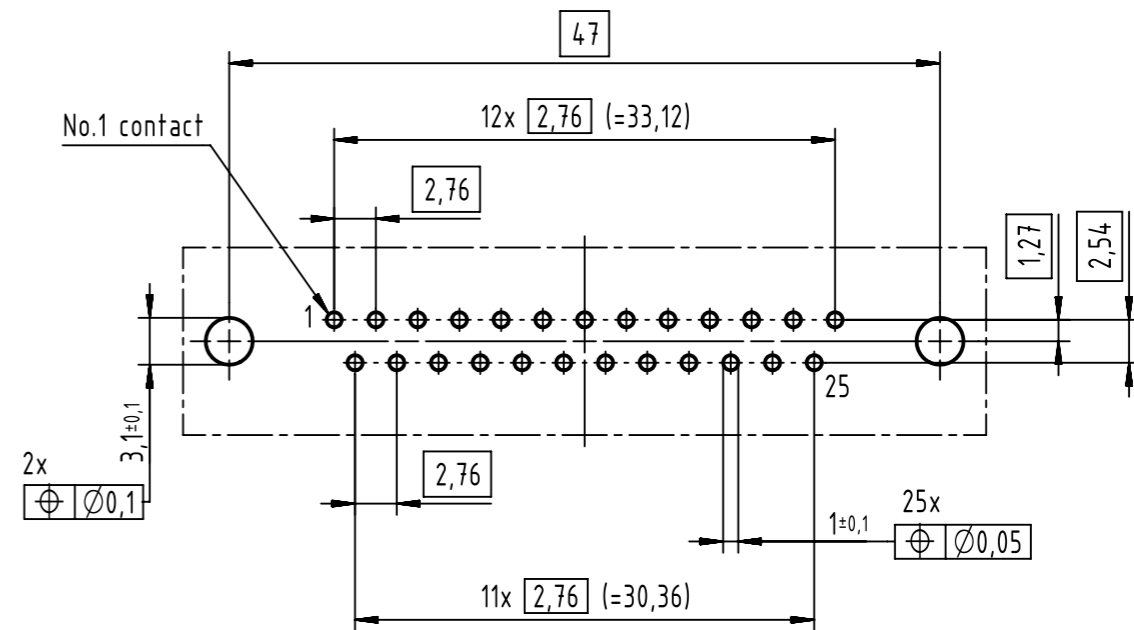

Mounting force on Printed board: 25-80 N

part number	Performance level	nut thread
0966 362 7813	AU3	4-40 UNC
0966 362 6813	AU2	4-40 UNC
0966 362 5813	0,76µm AU	4-40 UNC

	All Dimensions in mm Original Size DIN A3	Scale 2:1	Free size tol.	Ref.	
	All rights reserved Department EC PD - CN	Created by ZHUANGJ	Inspected by LUOK	Standardisation HOFFMANN	Date 2015-10-27
HARTING Electronics GmbH D-32339 Espelkamp	Title D-Sub STD 25-pole male 2,54mm pitch with screw lock			State Final Release	
	Type TB	Number 0966362X813	Doc-Key / ECM-Nr. 100643739/UGD/000/A 50000095926		Page 1/1
				Rev. A	