

Printed board layout (1,6±0,2 thick)
view component side
(PCB plating =Tin)

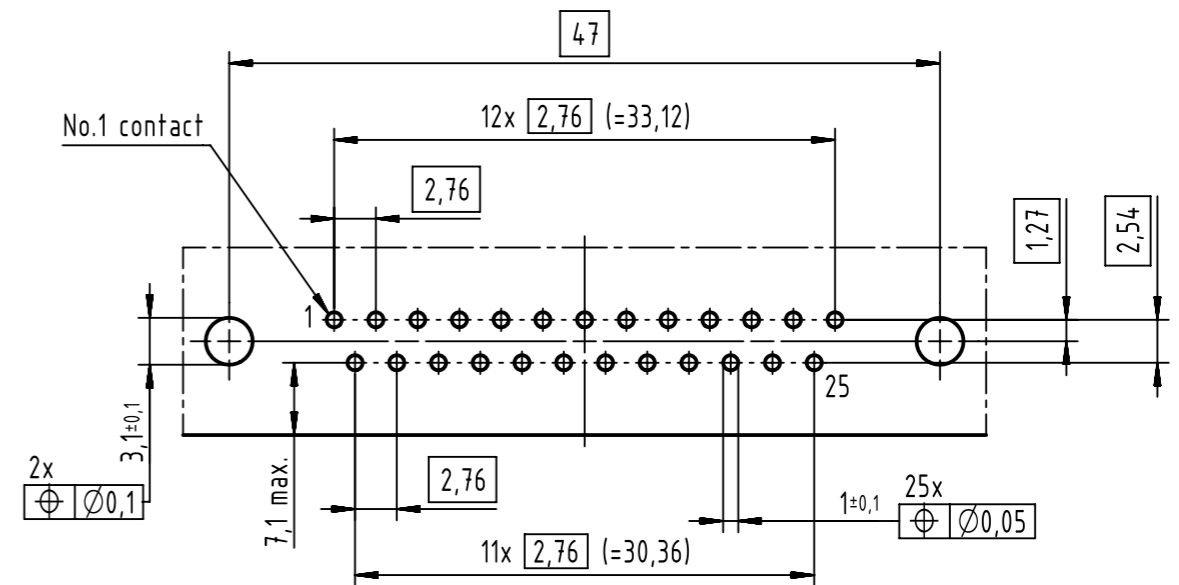

Mounting force on Printed board: 25-80 N

part number	Performance level	nut thread
0966 362 7817	AU3	4-40 UNC
0966 362 6817	AU2	4-40 UNC
0966 362 5817	0,76µm AU	4-40 UNC

	All rights reserved Department EC PD - CN HARTING Electronics GmbH D-32339 Espelkamp	All Dimensions in mm Original Size DIN A3	Scale 2:1	Free size tol.	Ref. Sub.
		Created by ZHUANGJ	Inspected by LUOK	Standardisation HOFFMANN	Date 2015-10-27
Title D-Sub 25-pole male low-profile ass with screw lock					Doc-Key / ECM-Nr. 100643737/UGD/000/A 50000095926
Type TB		Number 0966362X817		Rev. A	Page 1/1