

Printed board layout (1,6±0,2 thick)
view component side
(PCB plating = Tin)

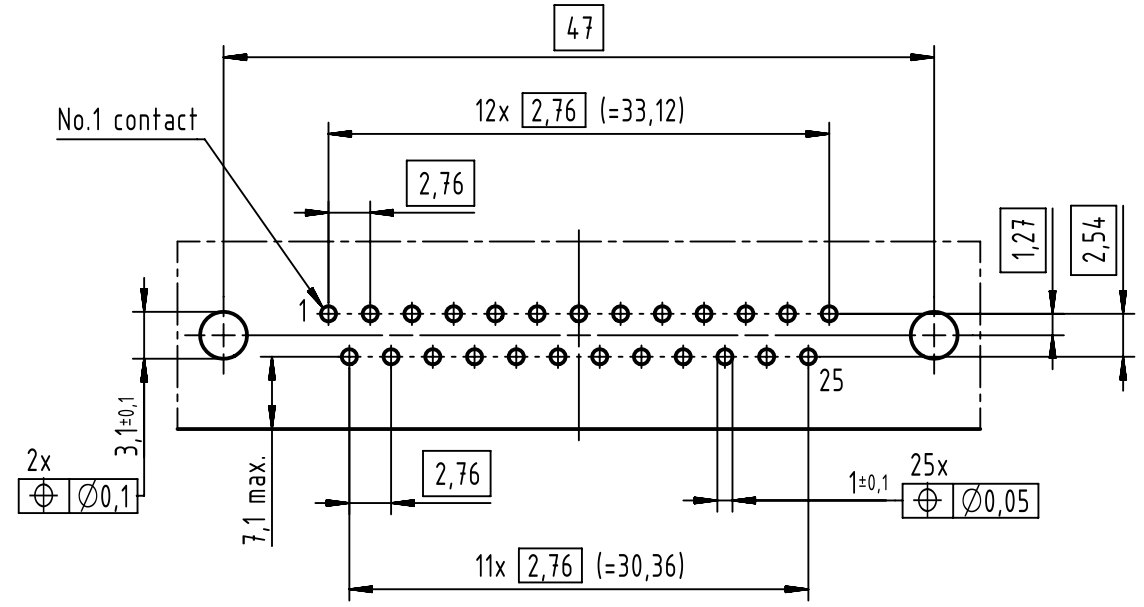

Mounting force on Printed board: 25-80 N

part number	Performance level	nut thread
0966 362 7815	AU3	M3
0966 362 7816	AU3	4-40 UNC
0966 362 6815	AU2	M3
0966 362 6816	AU2	4-40 UNC
0966 362 5815	0,76µm AU	M3
0966 362 5816	0,76µm AU	4-40 UNC

	All rights reserved	Created by	Inspected by	Standardisation	Date	State	
	Department EC PD - CN	ZHUANGJ	LUOK	HOFFMANN	2015-10-27	Final Release	
HARTING Electronics GmbH D-32339 Espelkamp		Title D-Sub 25-pole male low-profile assembly				Doc-Key / ECM-Nr. 100634565/UGD/000/A 50000095926	
		Type	Number	Rev.		Page	
		TB	0966362X81X	A		1/1	