

INSTRUCTION

REGIOLUX

Regiolux GmbH
 Hellinger Str. 3
 D-97486 Königsberg/Bay.
 Telefon (0 95 25) 89-0
 Telefax (0 95 25) 89 73 4
<http://www.regiolux.de>
 e-Mail: info@regiolux.de

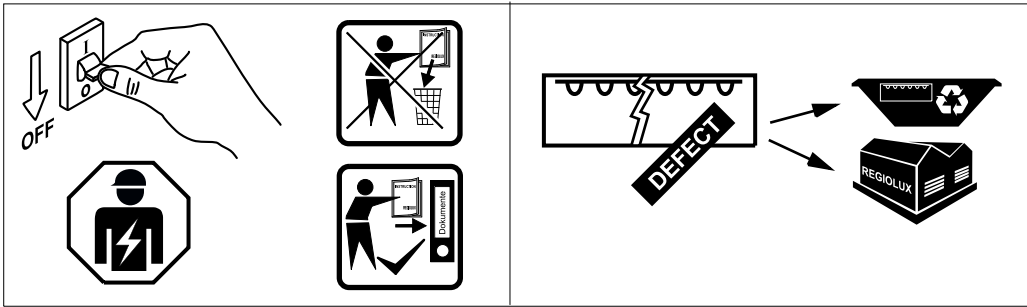

IP20

SRT-11A/0500 INKL. SRBK+SRTVL

1920 0013 ...

SRT-7A/0500 INKL. SRBK+SRTVL

1920 0012 ...

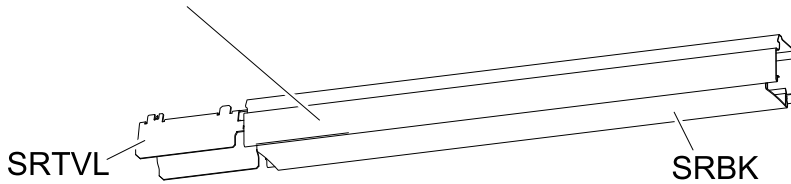

IP64

SRT-11A/0500 INKL. SRBKS+SRTVLS IP64

1920 0015 ...

SRT-7A/0500 INKL. SRBKS+SRTVLS IP64

1920 0014 ...

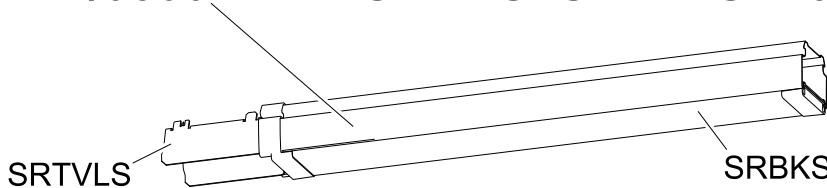

Option A Auspeisung

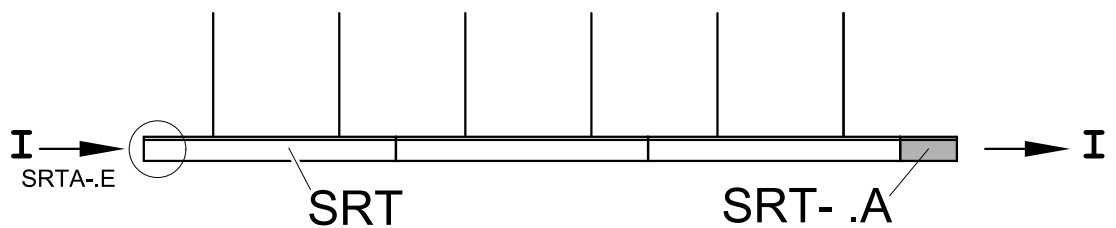

Option B Mitteneinspeisung

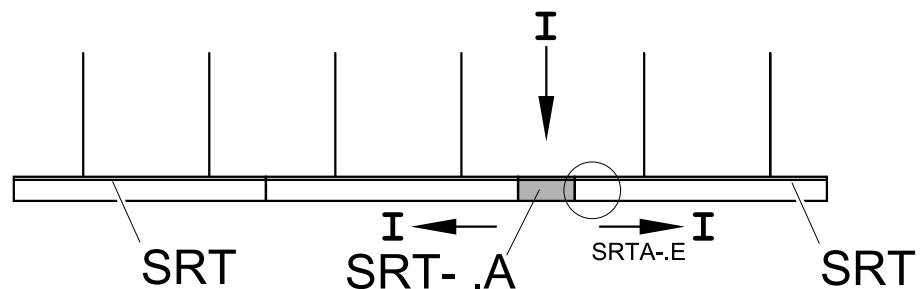

MONTAGE

Option A

SRT-.A

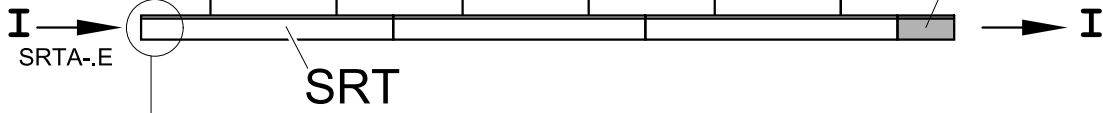

SRTA-11E / SRTA-7E

SRT-.A

1. Insert the SRT-.A component into the SRT housing.
2. Connect the SRT-.A component to the main assembly.
3. Push the SRT-.A component into the SRT housing.
4. Tighten the Torx 20 screw with a maximum torque of 2 Nm.
5. Push the SRT-.A component into the SRT housing.
6. Connect the SRT-.A component to the main assembly.
7. Push the SRT-.A component into the SRT housing.
8. Tighten the Torx 20 screw with a maximum torque of 2 Nm.

max 2 Nm Torx 20

optional SRT/SDT-MT 19209000100

push+click

S RTE
S RTES

10. Connect the S RTE / S RTES component to the main assembly.
11. Option 1: Connect the S RTE / S RTES component to the main assembly.
11. Option 2: Connect the S RTE / S RTES component to the main assembly.

U=400 V

1,5-2,5 mm²

8+1 mm

12. Connect the S RTE / S RTES component to the main assembly.

13. Connect the S RTE / S RTES component to the main assembly.

MONTAGE Option B

