

**EnOcean Easyclickpro flush-mounting
rec.for blinds/shutters, w.pos.detection**

Product Data Sheet

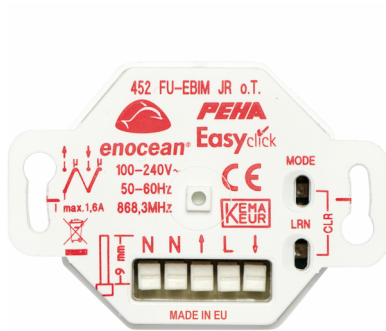

Empfänger Easyclick

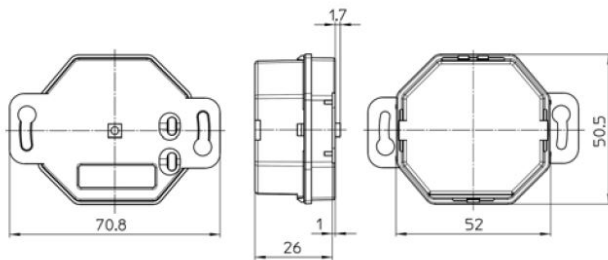

In housing	Yes
bi-directional	yes
Push button mode	Yes
Switching mode	No
With radio controlled push button	No
2 channel	no
Halogen free	Yes
potential-free contact	no
1 channel	no
with mounting plate	no
position detection	yes
Radio frequency	868Megahertz
energy metering	no
Current supply	230 V AC
Mounting method	Flush mounted (plaster)
Type of fastening	Mounting with screw
Colour	White
Suitable for degree of protection (IP)	IP20
information1	roller shutter/jalousie module

EnOcean Easyclickpro flush-mounting rec.for blinds/shutters, w.pos.detection

In addition to the bidirectional functions, the Easyclick receiver variant features position detection that can record and acknowledge the running times of shutters and blinds. Positions can then be visualised e.g. on the handheld transmitter D 450 FU-HS 128. The running times of the receivers are synchronised automatically when they reach their UP/DOWN end positions. The bidirectional Easyclick JR receiver can not only receive radio signals, but also transmits back its status every time it changes. For instance, the top/bottom end position of a shutter/blind can be depicted as a virtual image and visualised e.g. on the handheld transmitter D 450 FU-HS 128. The Easyclick receiver is designed to regulate shutters and blinds.

A range of functions and parameters can be selected:

- two-key operation UP/STOP/DOWN with slat adjust (standard function blind)
- two-key operation UP/STOP/DOWN w/o slat adjust (standard function shutter)
- jog mode (ON/OFF)
- one-key operation UP/STOP/DOWN
- safety lock for maintenance work
- automatic ON/OFF
- sun sensor / twilight sensor / wind sensor / rain sensor
- 4 possible positions TOP/BOTTOM for lighting scenes • lockout protection with window contact / window handle
- A function can be defined individually for each of the max 32 programmed transmitters
- Integrated repeater functions (1 level / 2 level) can be switched ON for each project, irrespectively of the set functions
- Separate preassigned functions and parameters when e.g. window contacts and window handles are being programmed

Technical data:

Own consumption: < 0.5 W (bistable relays)

Transmit frequency: 868.3 MHz

Voltage supply: 100–240 Vac/ 50–60 Hz

Neutral conductor: required

Ambient temperature: -20 °C to +40 °C

Storage temperature: -40 °C to +85 °C

Plugin terminals: max 1 x 1.5 mm²

Housing height: 28 mm

Rating: IP 20

Mounting lugs: for screwing down in switch sockets

Approvals: CE; KEMA/KEUR

Connecting data: I max 1.6 A

Material No.	Article No.	EAN-code
00366576	D 452 FU-EBIM JR O.T.	4010105366570

PEHA Elektro GmbH & Co.KG

a Honeywell Company
Daimlerstraße 4
58553 HALVER
DEUTSCHLAND

Tel.: 02353 9118 001
Fax: 02353 9118 311
mail: peha@honeywell.com
www.peha.de

Änderungen vorbehalten. © Honeywell PEHA