

Mod.	Dot.	Name	Detail.	Dot.	Name
34784	13/02/08	PK	Detail.	09/04/02	CV
33106	22/09/05	JMDR	Insp.		
31571	12/11/03	SH	Stand.		
31526	31/07/03	TCP	HARTING EURL F-95972 Paris		
29768	09/04/02	CV			

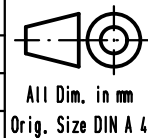

D-Sub, female, straight,
50 poles, for crimp contacts,
tin plated shell

TB 09 67 050 4701

Sub.

Maßstab/
Scale
1,5:1

Blatt/ Page
1 / 2

A

B

C

D