

Wall mounting appliance inlet - 7 poles, housing dimensions 126x83



| Product description | |
|---------------------------|----------------------------------|
| BALS-Prd.-Nr | 24196 |
| EAN | 4024941241960 |
| Product category | TE wall mounting appliance inlet |
| Current | 32A |
| Number of poles | 7p |
| Arrangement of phases | 6p+PE |
| Position of earth contact | 6 h |
| Voltage | 400V~ |

| Product description | |
|------------------------|----------------------------------------------------------------------------------------------------------|
| Frequency | 50/60Hz |
| Protection degree | IP44 |
| Colour code | red RAL 3000 |
| Colour of appliance | Collar red RAL 3000, Housing bottom grey RAL 7035, Housing top grey RAL 7035 |
| Connection design | with screw terminal |
| Maximum conductor size | 6,0 qmm |
| Cable entry | 1xM25 top, 2xM25 bottom |
| Height | 166mm |
| Width | 83mm |
| Depth | 130mm |
| Dimension of enclosure | 126x83 mm (HxW) |
| Material of enclosure | Polyamide |
| Contacts | The contact carrier is made of high temperature resistant material, the contacts are brass nickel plated |

| Additional technical properties | |
|---------------------------------|-------------------------------------------------------------|
| | The cable entry is one at top open and two at bottom closed |
| | Lower part of housing rotatable by 180° |
| | 4 cut out fixing holes in the lower part of housing |

| Logistics data | |
|----------------|------------------|
| Weight/pcs | 0.419 kg / Piece |
| Packaging | Bag |
| Content amount | 1 ST |
| EAN | 4024941241960 |
| Length | 130 mm |
| Width | 83 mm |
| Height | 166 mm |
| Weight | 0.42 kg |
| Volume | 1,791.14 ccm |
| Packaging | Carton |
| Content amount | 10 ST |
| EAN | 4024941822848 |
| Length | 330 mm |
| Width | 216 mm |
| Height | 260 mm |
| Weight | 4.416 kg |
| Volume | 17,062.5 ccm |

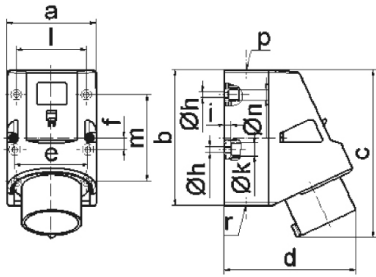

5 MB 185

| Ampere | 16 | 32 | | | | | |
|----------------------------|---------|---------|--|--|--|--|--|
| Polzahl | 7 | 7 | | | | | |
| a | 83,0 | 83,0 | | | | | |
| b | 126,0 | 126,0 | | | | | |
| c | 155,5 | 166,0 | | | | | |
| d | 122,0 | 130,0 | | | | | |
| e | 68,0 | 68,0 | | | | | |
| f | 11,0 | 11,0 | | | | | |
| h ø | 5,5 | 5,5 | | | | | |
| i | 6,5 | 6,5 | | | | | |
| k ø | 12,0 | 12,0 | | | | | |
| l | 65,0 | 65,0 | | | | | |
| m | 80,0 | 80,0 | | | | | |
| n ø | 10,0 | 10,0 | | | | | |
| p | M25 | M25 | | | | | |
| r | 2 x M25 | 2 x M25 | | | | | |
| Leiter mm ² min | 1 | 2,5 | | | | | |
| Leiter mm ² max | 2,5 | 6 | | | | | |