

Wall mounting socket outlet - straight, housing dimensions 102x102 mm



Product description	
BALS-Prd.-Nr	110567
EAN	4024941938648
product category (PG)	TE wall mounting socket outlet Quick-Connect
current (A)	16A
number of poles (P99)	5p
number of poles (P)	3p+N+PE
position of earth contact (H)	9 h
voltage (V)	120/208 up to 144/250V

Product description	
frequency (HZ)	50 and 60Hz
protection degree (SA)	IP67
colour code 1 (KF1)	blue RAL 5015
Colour of appliance	Hinged lid blue RAL 5015, Enclosure grey RAL 7035
connection design (AT)	screwless spring terminals as cage clamp with Kontex-contact
maximum conductor size (LQ)	4,0 qmm
cable entry (KE)	3 sides 2x M20/25, 1 side 1x M20/25, to break out
Height	102mm
Width	102mm
Depth	125mm
dimension of enclosure (GG)	102x102 mm (HxW)
material of enclosure (GM)	Polyamide
contact	The contact carrier is made of high temperature resistant material, the contacts are brass nickel plated

Additional technical properties	
	All cable entries are to break out

Logistics data	
Weight/pcs	0.375 kg / Piece
Packaging	Bag
Content amount	1 ST

Logistics data	
EAN	4024941938648
Length	125 mm
Width	102 mm
Height	102 mm
Weight	0.376 kg
Volume	1,300.5 ccm
Packaging	Carton
Content amount	10 ST
EAN	4024941827508
Length	325 mm
Width	217 mm
Height	210 mm
Weight	3.956 kg
Volume	13,588.4 ccm

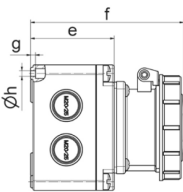
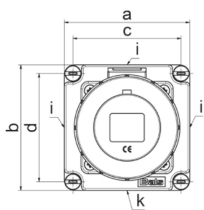

Ampere Polzahl	16 3	16 4	16 5	32 3	32 4	32 5
a	102,0	102,0	102,0	102,0	102,0	102,0
b	102,0	102,0	102,0	102,0	102,0	102,0
c	88,0	88,0	88,0	88,0	88,0	88,0
d	88,0	88,0	88,0	88,0	88,0	88,0
e	68,0	68,0	68,0	68,0	68,0	68,0
f	124,0	125,0	124,0	134,0	134,0	134,0
g	4,0	4,0	4,0	4,0	4,0	4,0
h ø	4,5	4,5	4,5	4,5	4,5	4,5
i	2xM20/25	2xM20/25	2xM20/25	2xM20/25	2xM20/25	2xM20/25
k	M20/25	M20/25	M20/25	M20/25	M20/25	M20/25
Leiter mm ² min	1,5	1,5	1,5	2,5	2,5	2,5
Leiter mm ² max	4	4	4	10	10	10

1 MB 121