

- D** D slide cover
klosz D wsuwany
- C** C click cover
klosz C klik
- U5** cone U5
mounting plate
uchwyt U5 cone
- 1** ARC12
D ending
zaślepka
ARC12 D
- 2** ARC12
ending
zaślepka
ARC12
- 3** power supply
cable
kabel zasilania
- 4** LED power
supply
zasilacz LED



pliers
kombinerki



hacksaw
piła



soldering iron
lutownica



solder
cyna



drill
wiertarka



screwdriver
śrubokręt

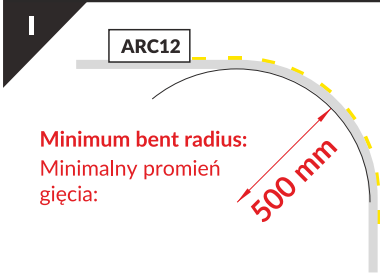

Minimum bent radius:
Minimalny promień
gięcia:

500 mm

Note! When bending to the outside (picture on the left), the needed length of the cover is greater than the length of the profile.
Uwaga! W przypadku gięcia profilu na zewnątrz (patrz rys. po lewej) potrzebna długość klosza jest większa niż długość profilu.

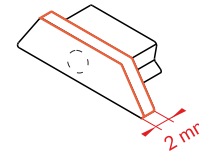
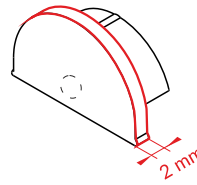

Note! Ending thickness increases the length of the luminaire by 2 mm each side.

Uwaga! Grubość zaślepki zwiększa długość oprawy o 2 mm z każdej strony.

Note! Endings with marked space to bore a hole.
Uwaga! Zaślepki z punktem do przewiercenia otworu.

MANUAL BENDING / RĘCZNE GIĘCIE

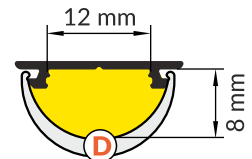
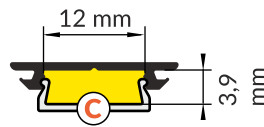
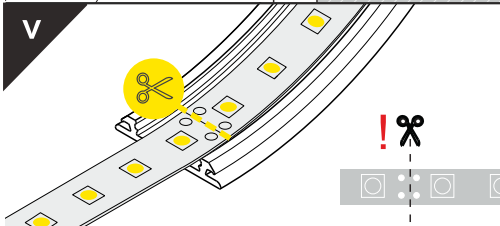
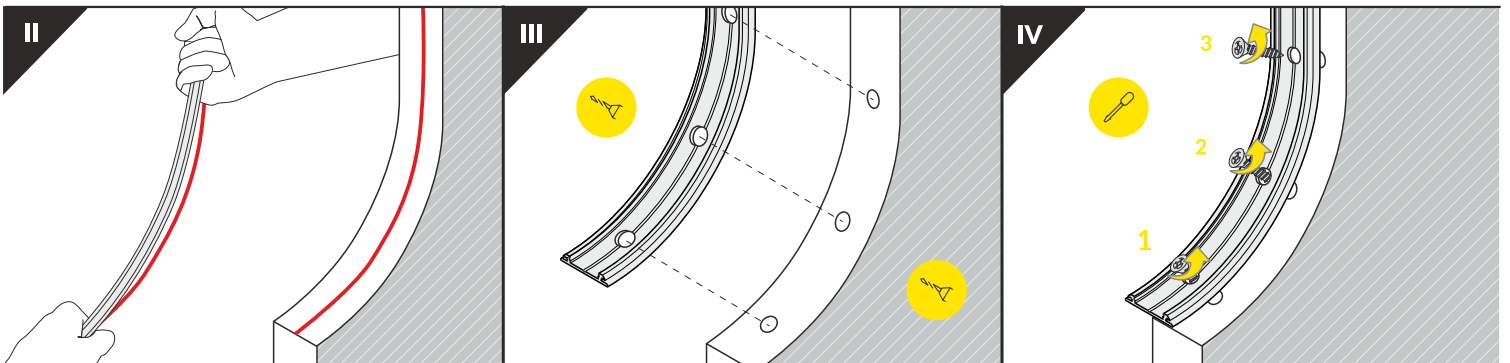

Dimensions of the space to install LED source. / Wymiary przestrzeni do zamontowania źródła LED.

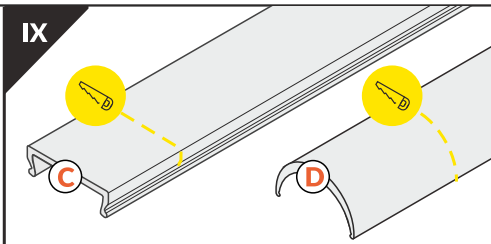
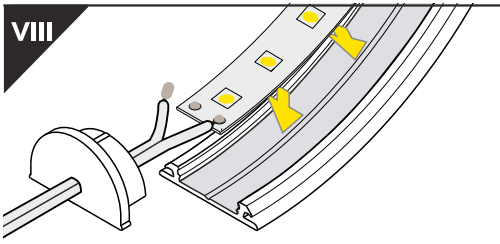
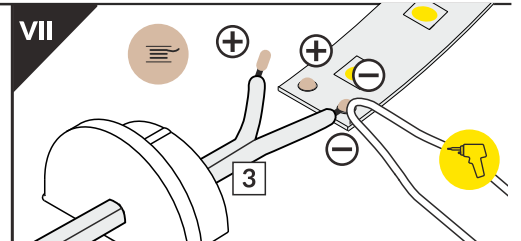
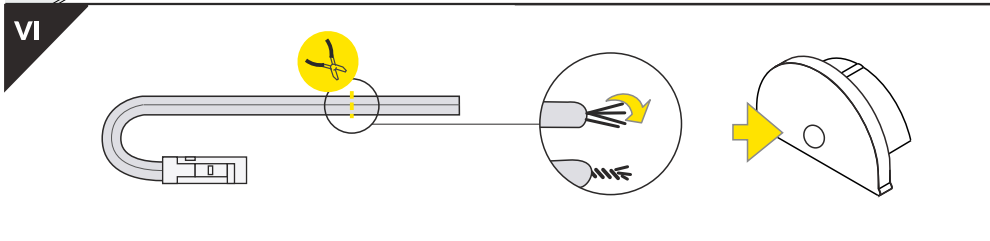

VI



C click cover / klosz C klik

D slide cover / klosz D klik

C + D for maximum light diffusion
dla maksymalnie rozproszonego światła

VII MOUNTING / MONTAŻ

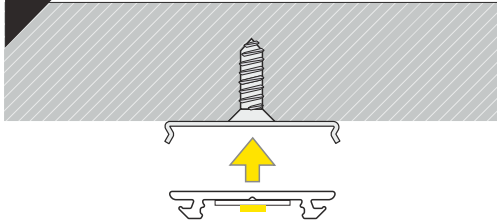
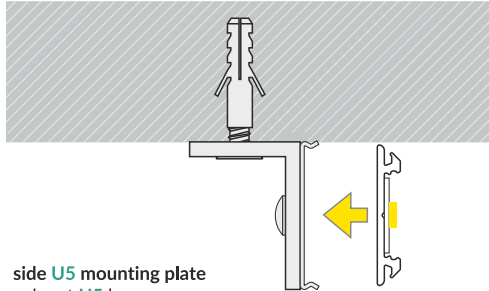
cone U5 mounting plate
uchwyt U5 coneside U5 mounting plate
uchwyt U5 boczny

SLING / ZAWIESIE

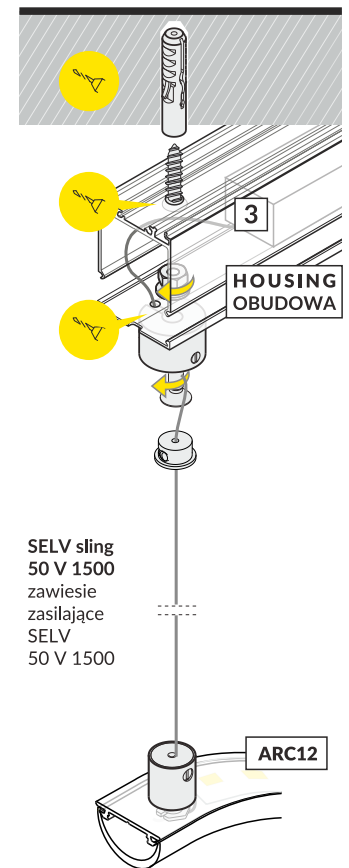
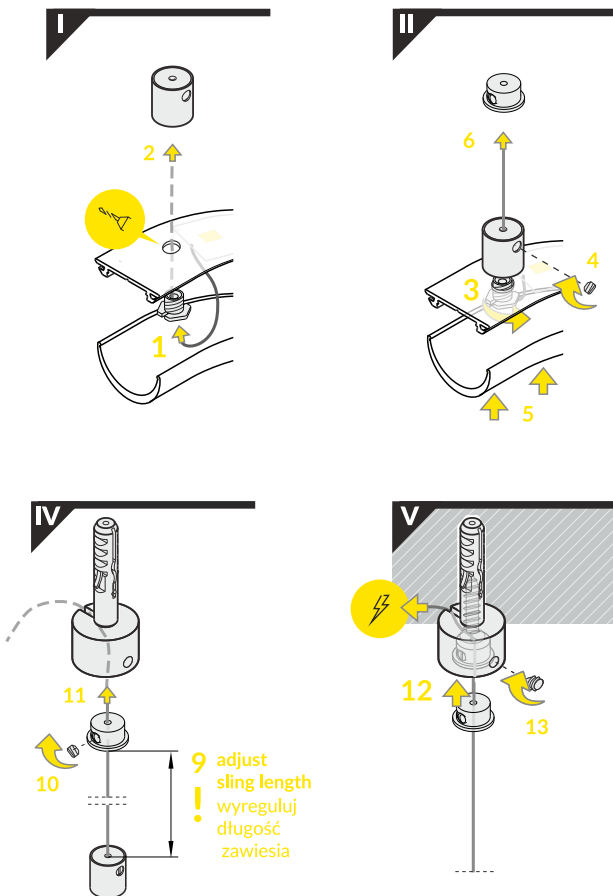
SELV sling 50 V 1500
zawiesie zasilające SELV 50 V 1500SELV sling + LED power supply housing
zawiesie SELV + obudowa na zasilaczSELV sling
50 V 1500
zawiesie
zasilające
SELV
50 V 1500

ARC12

IX

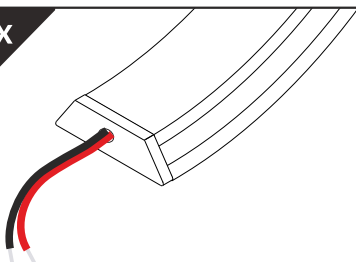

12V/24V

230V

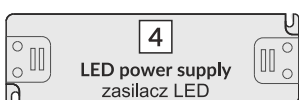
LED power supply
zasilacz LED

ACCESSORIES / AKCESORIA

- power switches
- controller + remote
- movement sensors
- włączniki
- sterownik + pilot
- czujniki ruchu

www.tlg.no