

# Montageanleitung

P794-74 Bohr-Fixx Set 74 mm

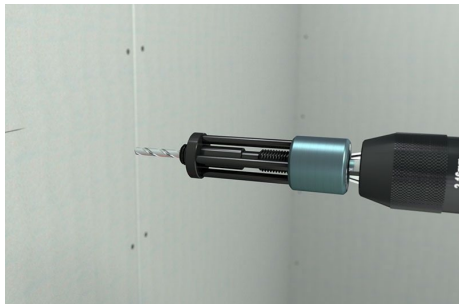

Zentrierbohrer in die Aufnahme stecken.

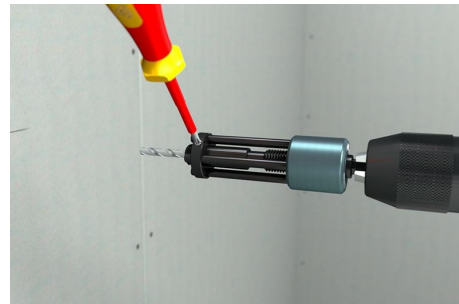

Zentrierbohrer mit seitlicher Befestigungsschraube fixieren.

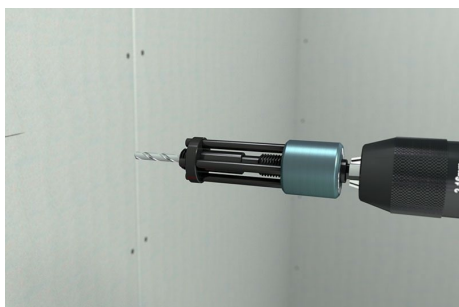

Aluminiumhülse zurückziehen.

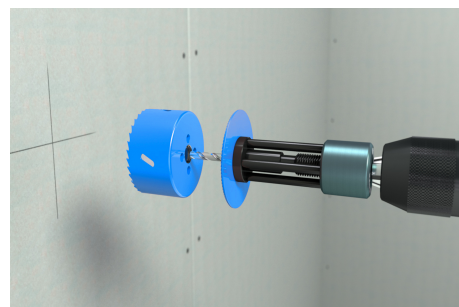

Bohrkrone aufschrauben. Wenn benötigt zuvor Randversenker (separat erhältlich) einsetzen.

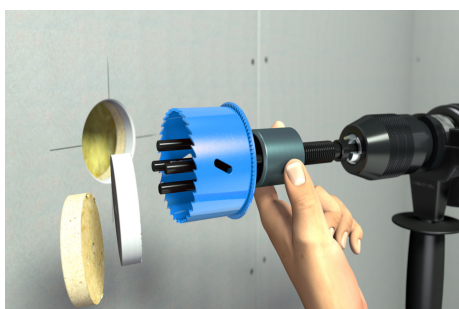

Aluminiumhülse festhalten und Bohrkern durch Linkslauf der Bohrmaschine auswerfen lassen.

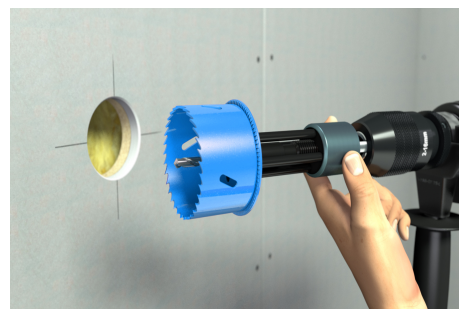

Aluminiumhülse festhalten und durch Rechtslauf der Bohrmaschine Adapter in Ausgangsposition zurückführen.

## Assembly instruction

### P794-74 Drill-Fixx set 74 mm

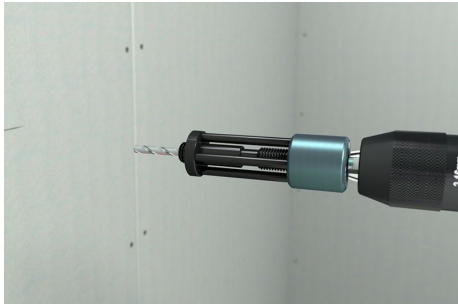

Insert the centering drill into the holder.

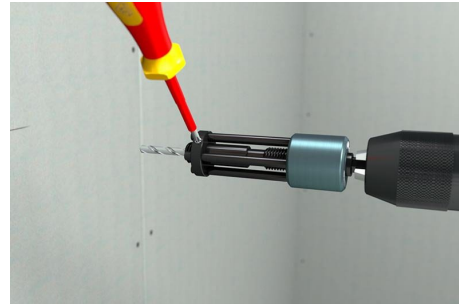

Fix the centering drill with fixing screw on the side.

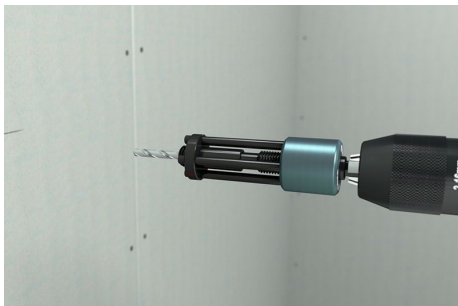

Pull back the aluminum sleeve.

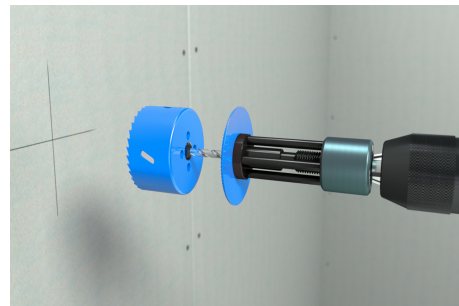

Screw on the drill bit. If required use a countersink (available separately).

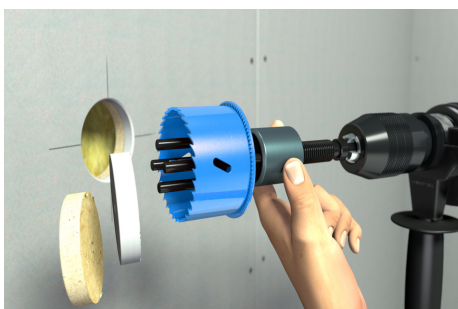

Hold the aluminum sleeve and allow the drill core to be ejected by turning the drill to the left.

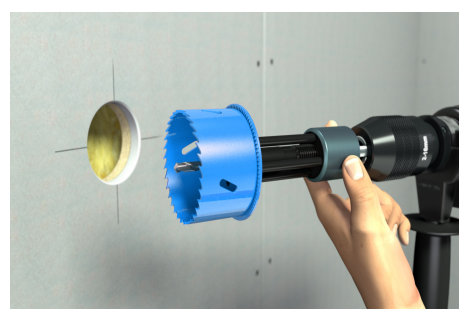

Hold the aluminum sleeve and return the adapter to the starting position by turning the drill clockwise.