

## Wall mounting appliance inlet - housing dimensions 126x83



| Product description       |  |
|---------------------------|--|
| BALS-Prd.-Nr              | 24629  |
| EAN                       | 4024941947602                                  |
| Product category          | TE wall mounting appliance inlet Quick-Connect |
| Current                   | 32A  |
| Number of poles           | 4p   |
| Arrangement of phases     | 3P+PE  |
| Position of earth contact | 5 h  |
| Voltage                   | 600 - 690V~                                    |

| Product description    |  |
|------------------------|--|
| Frequency              | 50/60Hz  |
| Protection degree      | IP44   |
| Colour code            | black RAL 9005   |
| Colour of appliance    | Collar black RAL 9005, Housing bottom grey RAL 7035, Housing top grey RAL 7035                           |
| Connection design      | screwless spring-clamp technology  |
| Maximum conductor size | 6,0 qmm  |
| Cable entry            | 1xM25 top, 2xM25 bottom  |
| Height                 | 166mm  |
| Width                  | 83mm   |
| Depth                  | 128mm  |
| Dimension of enclosure | 126x83 mm (HxW)  |
| Material of enclosure  | Polyamide  |
| Contacts               | The contact carrier is made of high temperature resistant material, the contacts are brass nickel plated |

| Additional technical properties |   |
|---------------------------------|---|
|                                 | The cable entry is one at top open and two at bottom closed |
|                                 | Lower part of housing rotatable by 180°                     |
|                                 | 4 cut out fixing holes in the lower part of housing         |

| Logistics data |                 |
|----------------|-----------------|
| Weight/pcs     | 0.38 kg / Piece |
| Packaging      | Bag             |
| Content amount | 1 ST            |
| EAN            | 4024941947602   |
| Length         | 128 mm          |
| Width          | 83 mm           |
| Height         | 166 mm          |
| Weight         | 0.381 kg        |
| Volume         | 1,763.584 ccm   |
| Packaging      | Carton          |
| Content amount | 10 ST           |
| EAN            | 4024941838023   |
| Length         | 330 mm          |
| Width          | 216 mm          |
| Height         | 260 mm          |
| Weight         | 4.026 kg        |
| Volume         | 17,062.5 ccm    |

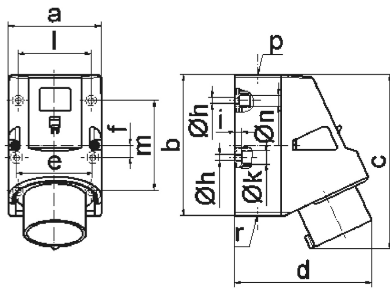

5 MB 45

| Ampere                     | 16    | 32    | 32    | 32    |
|----------------------------|-------|-------|-------|-------|
| Polzahl                    | 5     | 3     | 4     | 5     |
| a                          | 83,0  | 83,0  | 83,0  | 83,0  |
| b                          | 126,0 | 126,0 | 126,0 | 126,0 |
| c                          | 155,5 | 165,0 | 165,0 | 166,0 |
| d                          | 122,0 | 128,0 | 128,0 | 130,0 |
| e                          | 68,0  | 68,0  | 68,0  | 68,0  |
| f                          | 11,0  | 11,0  | 11,0  | 11,0  |
| h ø                        | 5,5   | 5,5   | 5,5   | 5,5   |
| i                          | 6,5   | 6,5   | 6,5   | 6,5   |
| k ø                        | 12,0  | 12,0  | 12,0  | 12,0  |
| l                          | 65,0  | 65,0  | 65,0  | 65,0  |
| m                          | 80,0  | 80,0  | 80,0  | 80,0  |
| n ø                        | 10    | 10,0  | 10,0  | 10,0  |
| p                          | M25   | M25   | M25   | M25   |
| r                          | 2xM25 | 2xM25 | 2xM25 | 2xM25 |
| Leiter mm <sup>2</sup> min | 1     | 2,5   | 2,5   | 2,5   |
| Leiter mm <sup>2</sup> max | 2,5   | 6     | 6     | 6     |