

### TECHNISCHE DATEN:

#### Aufbau

Verschlusschraube Polyamid PA6 GF30 V-0  
Anschlussgewinde metrisch, nach EN 60423

#### Eigenschaften

- zum sicheren Verschließen einer nicht benutzten Gewinde- oder Durchgangsbohrung

Temperaturbereich -55 °C / +120 °C  
Schutzart IP55

### TECHNICAL DATA:

#### Configuration

Screw plug Polyamide PA6 GF30 V-0  
Connecting thread metric, as per EN 60423

#### Properties

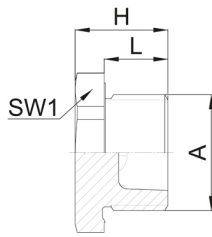

- for secure sealing of unused threaded or clearance hole

Temperature range -55 °C / +120 °C  
Protection grade IP55



### Merkmale

### Characteristics

| A       | L<br>mm | SW1<br>mm | H<br>mm |  |  RAL 7035<br>lichtgrau<br>light grey<br>Art.-Nr. / Part No. |  RAL 9005<br>tiefschwarz<br>jet black<br>Art.-Nr. / Part No. |
|---------|---------|-----------|---------|---|--|---|
| M12x1,5 | 10      | 16        | 15      | 100   | V301-1012-11   | V301-1012-01  |
| M16x1,5 | 10      | 21        | 15      | 100   | V301-1016-11   | V301-1016-01  |
| M20x1,5 | 11      | 25        | 16      | 100   |  | V301-1020-01  |
| M25x1,5 | 11,5    | 30        | 17,5    | 100   |  | V301-1025-01  |
| M32x1,5 | 13      | 37        | 20      | 50  | V301-1032-11   | V301-1032-01  |
| M40x1,5 | 13      | 46        | 20      | 25  |  | V301-1040-01  |
| M50x1,5 | 15      | 56        | 23      | 25  |  | V301-1050-01  |
| M63x1,5 | 15      | 69        | 23      | 25  |  | V301-1063-01  |